

How to mount torsion spring tray assy (1)

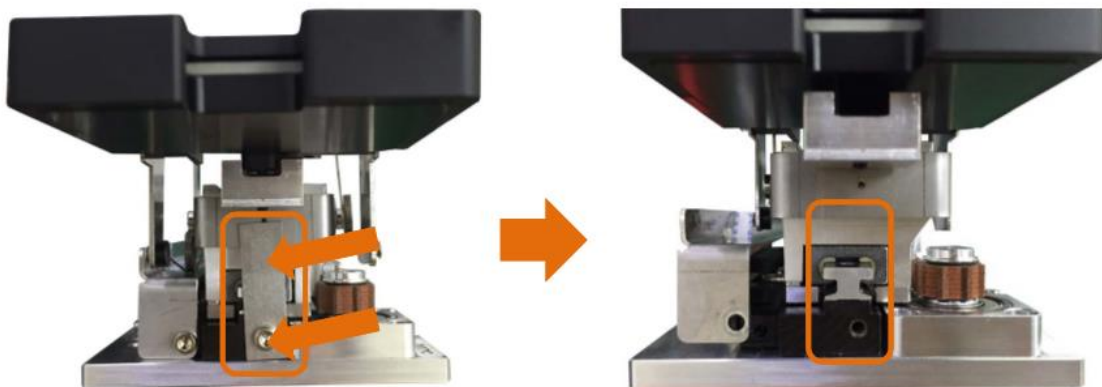

- Please take off 1,2,3 assembly. Please be careful electronic connection.



- Please screw out point bolt and take off original ejector guide then swap it to new ejector guide.



- Please screw out point 3 bolts.

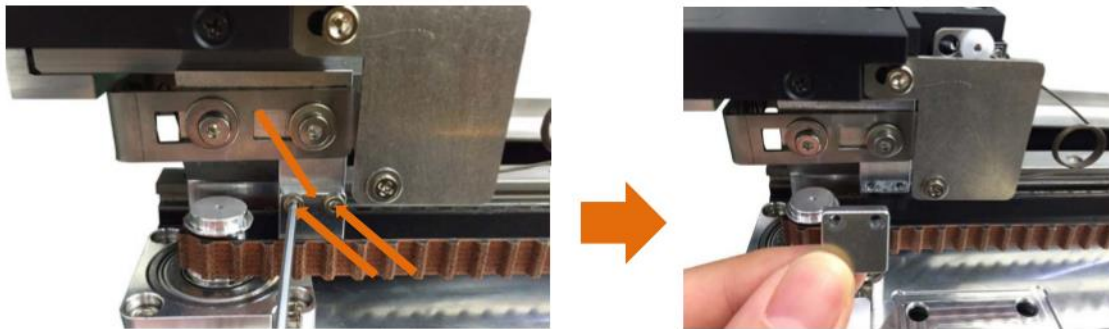

- Please screw out point 2 bolts and square metal part.

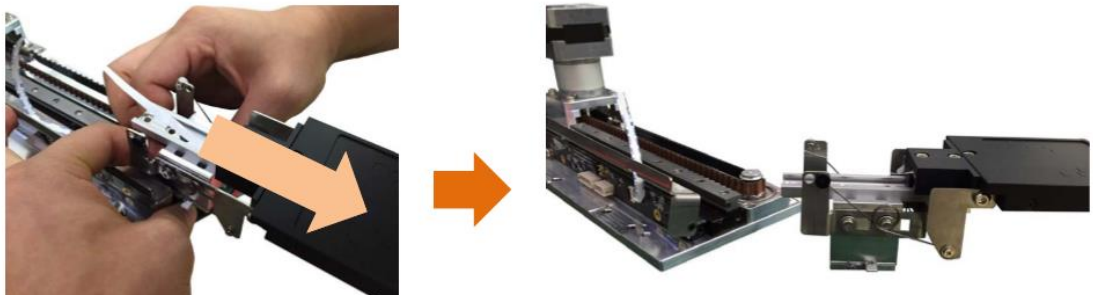

- Please take out tray assy'. Make sure that there's home sensor at the bottom of left side and making little bit wide with using hand finger so that tray can be out easily.

- You installed a sub tray assembly and ejector guide in the reverse order.



[Ejector guide]

- After installing them, please check the tray movement with covers off, and then test the torsion spring on the left to make sure it does not interfere with the white sticker.
- Move the sticker up if the spring makes contact.

